



Wall: Timber construction

Windtight and rainproof on the outside

Joining window to facade membrane



- Pre-fold the corner using Wigluv 20/40
- Affix precisely in the window corner
- Repeat at all corners



Connect corners:

- Align Wigluv 20/40 in the corner
- Remove narrow backing strip
- Affix the narrow side to the window frame and press on

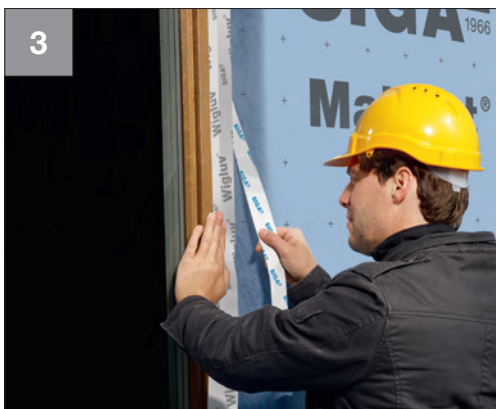

- Remove the wide backing strip
- Affix the wide side to the facade membrane and press on firmly

Wall: Timber construction Windtight and rainproof on the outside



4

How it should look:

- Window sealed windtight using Wigluv 20/40

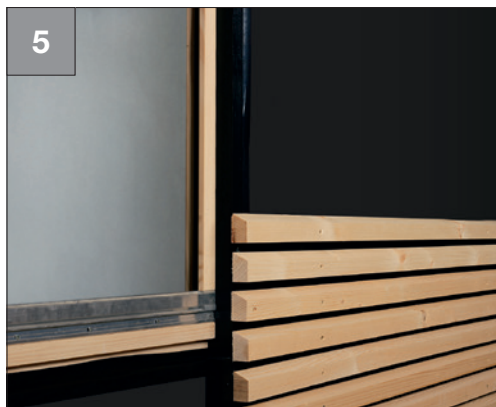

5

How it should look:

- The window next to a visible facade is sealed windtight with Wigluv black 20/40
- Suitable for facades with joint holes of ≤ 50 mm and a surface proportion of max. 40%

For closed facades:



Wigluv® 20/40

P. 129

For open facades:



Wigluv® black 20/40

P. 131



Wall: Timber construction

Windtight and rainproof on the outside

Joining window alternatively to facade membrane



- Bond to windowsill joint profile **at the bottom**
- Projecting by joint width plus approx. 6 cm on both sides
- Press on firmly

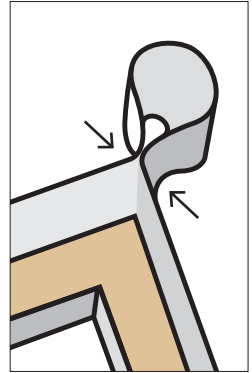

- Bond laterally to the frame
 - Press on firmly
- Top corners:**
- Form a loop: 1.5 x joint width
 - Bond or press together firmly
 - Repeat on the other side

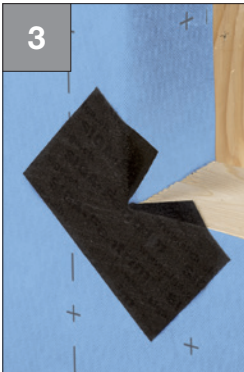

- Install the window
- Suggestion: Mount a wedge for better water discharge $\geq 5\%$.
- Bond bottom edge diagonally
- Form trough



- Cut into the corners
- Bond Fentrim over the complete sill depth

Wall: Timber construction Windtight and rainproof on the outside

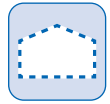

- Bond Fentrim laterally over the complete reveal depth



- Cut into top corners
- Fold over and bond the excess
- Bond top corners diagonally, cut in, fold over and press on firmly

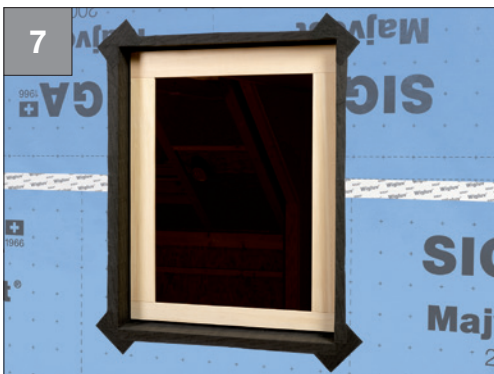

How it should look:

- Window frame joined to facade membrane impermeable to driving rain and windtight

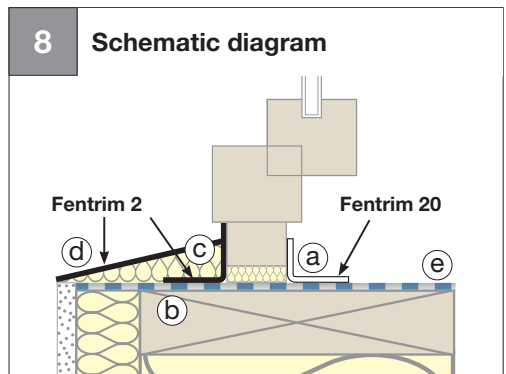

- Airtight connection (a) with Fentrim 20 / Fentrim IS 20
- Wind and driving rain-proof connection (b) with Fentrim 2 / Fentrim IS 2
- Slope wedge (c) with $\geq 5^\circ$ slope
- **Second water-draining layer (d)** with Fentrim IS 2
- Optional: temporary weather protection (e), e.g. with Wiglulv 300